

FieldConxTM Fiber Optic Field-Installable Connectors and Tools

Installation Instructions

LC Universal Type

Tools Needed:



****Note:** Connector, tail boots, pusher, and dust free wipe are included when purchasing the connector. Our other tools and supplies are sold separately.

For Drop Cable



Step 1: Put the tail boot onto the cable.

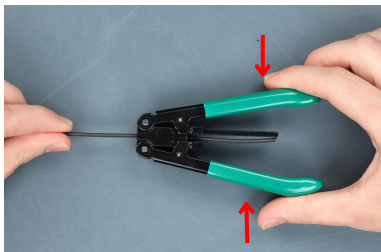

Step 2: Insert the cable in the drop cable stripper to at least the 5cm mark and strip the jacket from the fiber.

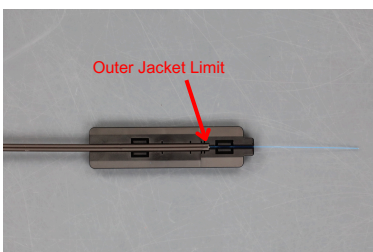

Step 3: Fix the cable into the cutting jig. The outer jacket must meet the outer jacket limit.

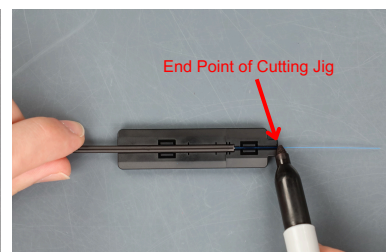

Step 4: Mark the 250µm acrylate at the end point of the cutting jig.



Step 5: Strip off the 250µm acrylate coating back to the added mark—stripping off the mark in the process.

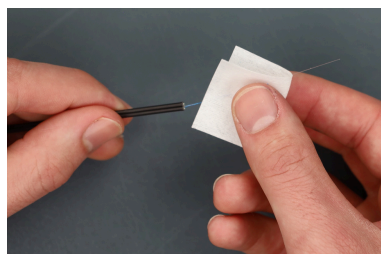

Step 6: Clean the bare fiber with the dust-free wipe.



Step 7: Fix the fiber in the cutting jig. The outer jacket must meet the outer jacket limit. The 250µm acrylate coating should meet the end of the cutting jig.



Step 8: Slide the cutting jig in the holder slot of the cleaver until it meets the clamp pad. Cleave fiber.

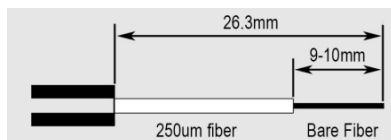

Note: The appropriate lengths of fiber and jacketing after cleaving.

****Photo Not to Scale**

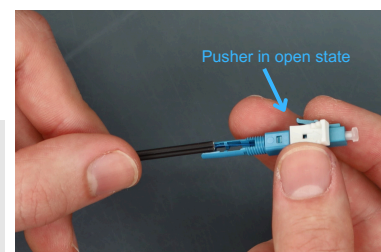

Step 9: Ensure the connector is in the open state by checking that the pusher stick is down near the base of the connector's housing.

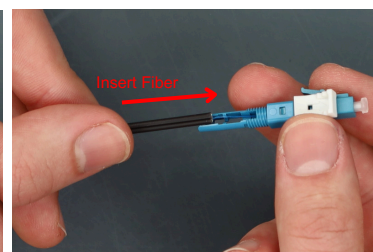

Step 10: Insert the fiber into the connector until the fibers meet inside—you'll feel resistance.

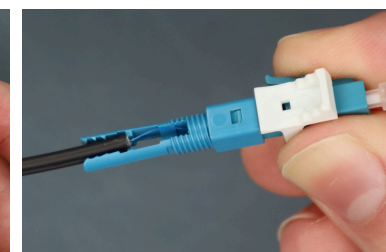

Note: There should be a slight bend in the fiber.

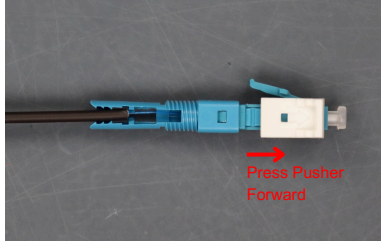

Step 11: Press the pusher forward to lock the fiber.

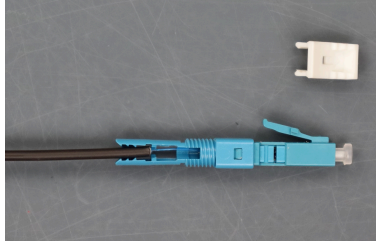

Step 12: Remove the pusher.
****Note:** Do NOT discard the pusher¹



Step 13: Screw the tail boot up all the way to complete the assembly.

¹ - Connectors can be re-terminated at least 3 times.